



cork

Go
Essence
Resist⁺



stone

Go
Essence
Resist⁺
Hydrocork



wood

Go
Essence
Resist⁺
Resist⁺
Hydrocork

INSTALLATION INSTRUCTIONS FOR WICANDERS HYDROCORK



GENERAL INFORMATION

Hydrocork floors are intended for indoor use only.

Please read the following instructions before installation.

- Hydrocork connection system is designed to be installed in a vertical connection by pressuring from top to bottom (without making any angles).
- Packed planks should be acclimatized at the job site in a dry, well ventilated area for a minimum of 48 hours so that flooring may acclimate.
- Acclimatization and installation temperature should be between 18°C to 28°C (65°F to 82°F).
- Never install Hydrocork PressFit on top of soft subfloors such as carpets, carpet tiles and similar
- Wooden subfloors or particle board subfloors must be mechanically fixed, e.g. by using screws, all tongue and groove joints should be glued with a suitable adhesive and the joints firmly closed
- Make sure the subfloor meets the requirements of Hydrocork PressFit installation. Please read carefully the subfloor preparation section.
- Hydrocork should be protected from heat and sunlight by the use of curtains and/or blinds. In areas that will be exposed to excessive heat or direct sunlight ($\geq 45^{\circ}\text{C}/110^{\circ}\text{F}$) the flooring should be glued to the subfloor with the use of acrylic adhesive.
- For Hydrocork installation no underlay is required. If you wish to use an underlay it must comply with specific requirements. Please check Wicanders auxiliary product selector.
- Hydrocork PressFit shade variation is an inherent and attractive characteristic. To achieve the most pleasant blend of shades, shuffle the floor panels enough to avoid identical, lighter or darker, panels next to each other.
- Make sure that the expansion gaps are minimum 5 to 10mm and do not install any permanent and heavy structures like kitchen islands or cabinets on top of Hydrocork. These requirements can be avoided, if Hydrocork PressFit is installed as a glue down (see glue down installation instructions).
- Installation area should be kept very clean from dust and small grains during installation
- It is recommended to plug off the floor heating system during installation.



cork

Go
Essence
Resist⁺



stone

Go
Essence
Resist⁺
Hydrocork



wood

Go
Essence
Resist
Resist⁺
Hydrocork



PRIOR TO INSTALLATION

Transport, storage and acclimatization

Transport and store the cartons horizontally.

Packed tiles should be acclimatized at the job site in a dry, well-ventilated area for a minimum of 48 hours so that flooring may acclimate.

Remove tiles from packages just before starting the installation.

During storage and installation, maintain temperature and relative humidity to a level consistent with the conditions which will prevail when the building is occupied. In most cases, this means maintaining a temperature range from 18°C to 28°C (65°F to 82°F) and relative humidity range from 35% to 65%. In order to reach this climate, use heating or air conditioning in the appropriate duration of time before starting the installation.

Wicanders shade variation is an inherent and attractive characteristic. To achieve the most pleasant blend of shades, shuffle the planks before installation.

Site inspection

Prior to installation, please inspect the tiles in daylight for any visible faults or damage, and also check if the subfloor and site conditions are in accordance with the specifications described within these instructions.

Amorim Revestimentos cannot be held responsible for claims associated with improper subfloors, improper applications, adhesives, varnishes and the use of maintenance products not recommended, or detectable defects verifiable prior to installation.

Subfloor requirements

Please inspect the planks in daylight for any visible faults or damage. Also check if the subfloor and site conditions are in accordance with the specifications described within these instructions.

Hydrocork PressFit can be installed in all domestic areas and in most commercial areas, except in saunas and permanent wet areas.



cork

Go
Essence
Resist⁺



stone

Go
Essence
Resist⁺
Hydrocork



wood

Go
Essence
Resist
Resist⁺
Hydrocork

It is possible to use Hydrocork PressFit in other areas like bathrooms, or areas where spillages frequently occur since it will not swell when exposed to water. However, in order to prevent the water to penetrate under the installed floor (which can create conditions for growing of fungus, mould or smell), a polyurethane sealant must be applied on expansion joints

Wicanders floors are suitable for indoor use only.

Hydrocork PressFit can be installed on top of most hard surfaces such as resilient floor coverings and ceramic tiles which are sufficiently fixed, completely levelled and have no loose areas. Soft subfloors such as carpets and similar must be removed.

For Hydrocork installation no underlay is required. Please check Wicanders auxiliary product list.

Old resilient floor coverings (like pvc, linoleum, cork...) must be glued without loose areas.

Hydrocork PressFit on wooden floor / chipboard / OSB.

In case of installation on a wooden subfloor, please remove any existing floor covering first. No signs of mould and/or insect infestations should be visible.

Make sure that the plywood and OSB subfloor are mechanically fixed (screw), make sure that they are stable and show no movement anytime and at the same time the joints between the panels are even and firmly closed.

Existing laminate flooring, wood planks or engineered wood planks must be free of tensions. If there are any visible open seams and/ or height differences between panels than needs to be entirely removed.

Existing wood planks, engineered wood boards, OSB panels, drywall elements etc. must not be covered with PE foil acting as a vapour barrier. The area below the floor should also be sufficiently ventilated in an adequate way (back-vented skirting board) to maintain the equilibrium moisture content of the wood planks, engineered wood boards, OSB panels, drywall elements.

The crawl space under the wooden subfloor must be sufficiently ventilated.



cork

Go
Essence
Resist⁺



stone

Go
Essence
Resist⁺
Hydrocork



wood

Go
Essence
Resist
Resist⁺
Hydrocork

Remove any obstacles from the crawl space and make sure there is sufficient ventilation (minimum 4cm² (0.62" ²) total ventilation openings per 1m² (3sqft) of flooring). The moisture content of the wood must not exceed 10%.

HydroCork PressFit on ceramic tile floors

The maximum joint should not be wider than 2mm (0.08"), and 1mm (0.04") depth. If this is not the case, or if there is any kind of embossing, skim coat the grout lines with a floor leveller).

All types of concrete, ceramic subfloors must be even, dry, variations should not exceed 3mm in 2m (0.12" in 6.6 feet) and flat.

Radiant-Heated Subfloors

For Wicanders floating floors the temperature of the subfloor must not exceed 28°C (82°F). For detailed information, follow the instructions supplied by the subfloor heating system manufacturer/contractor, or contact your supplier.

Remember that rugs or mats placed on top of the floor may function as heat accumulators and will increase the floor surface temperature more than the maximum surface temperature recommended (must not exceed 20 - 22 °C).

Installation of Wicanders Floors over Heated Subfloors:

Any Heated Subfloor has certain working conditions depending on the heating system and the subfloor.

In order to avoid problems with functioning and durability during the construction phase, the norms and rules concerning installation are to be followed very strictly.

The drying of a heated subfloor has to be made by turning the heating on/off with a pause before installation of the floor, following a documented protocol. After that you can begin the "heating phase".

The beginning of the heating phase in concrete subfloors is to be made not before 21 days after complete curing of the substrate. The heating phase has to begin with running temperature of 25°C (78°F) during 3 days.

The subfloor should be in place and cured for at least 60-90 days.



cork

Go
Essence
Resist+



stone

Go
Essence
Resist+
Hydrocork



wood

Go
Essence
Resist
Resist+
Hydrocork

The temperature should then be increased each day until the maximum temperature allowed according to the manufacturer system. This maximum value should be kept for at least 72 hours and maintained for 5-7 days without any turning off. The decrease of temperature is made by reducing it gradually every day until 18°C on the surface is achieved.

During the installation, the temperature of the surface should not exceed 18°C (65°F) and should be kept for 3 days after finishing the installation (for floating floors). Then the temperature should be increased slowly to a max. of 28°C (82°F) on the subfloor surface.

Moisture Protection

Despite its age, there is always a risk of moisture in subfloors, so it is necessary to measure and keep recorders of the moisture content of the subfloor.

Due to environment and indoor air quality, Wicanders Hydrocork should not be installed where excessive moisture emissions may exist, in accordance with applicable standards.

On concrete subfloors without radiant heat, consider the maximum humidity less than 75% RH or conduct calcium chloride moisture tests to ensure that moisture emission levels are less than 3 lbs/1000ft²/24 hours (USA and Canada), or CM Test:

Type of Subfloor	Moisture content CM%	
	Heated	Non-heated
Concrete	1,5	2,0
Anhydrite	0,3	0,5



cork

Go
Essence
Resist+



stone

Go
Essence
Resist+
Hydrocork



wood

Go
Essence
Resist
Resist+
Hydrocork

DURING INSTALLATION

Expansion Gaps:

Wicanders floating floors are installed as a "floating floors", so the planks should not be fixed to the subfloor.

The skirting boards/mouldings cannot be pressed down, not restricting the movement of the floor. Also provide 5mm (0.2") to 10mm (0.4") expansion gaps to the walls and other fixed objects. Skirting boards/mouldings should cover minimum 7mm (0.28") of the floor.

Transitions between two rooms and asymmetrical floor areas require extra expansion gaps in floor areas superior to 100m² (1000sqft) or with dimensions bigger than 10m (30 feet) in either direction.

These requirements can be avoided, if Hydrocork PressFit is installed as a glue down (see glue down installation instructions).

Installation with excessive heat or direct sunlight

Hydrocork should be protected from heat and sunlight by the use of curtains and or blinds. In areas which will be exposed to excessive heat (≥ 45 °C /110 °F) or direct sunlight the flooring must be glued to the subfloor with the use of an acrylic adhesive.

Tools required

Tape measure, craft knife, pencil, straight edge, chalk line, white rubber hammer or hand roller

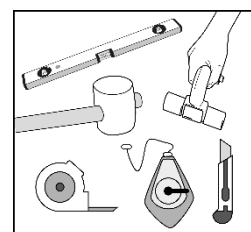



cork

Go
Essence
Resist+



stone

Go
Essence
Resist+
Hydrocork



wood

Go
Essence
Resist
Resist+
Hydrocork

Laying

On wooden floors, we recommend laying, Hydrocork crossways to the existing floorboard.

Hydrocork connection system is designed to be installed in a vertical connection by pressuring from top to bottom (without making any angles).

We recommend start installing in the right-hand corner.
The tongue side of the plank should face the wall.
Maintain a gap between 5mm (0.2") and 10mm (0.4").

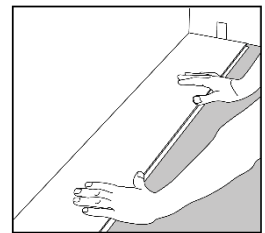

Hold the next plank tight to the short end of the first one matching the corner and then press it down with the help of a hand roller, or slightly tap with a rubber hammer.
Make sure that the long sides of the planks make a straight line.

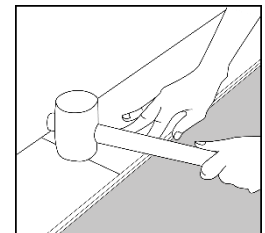

Complete first row in the same way and cut final plank of the first row to the correct length.
The distance to the wall should be 5mm (0.2") to 10mm (0.4").

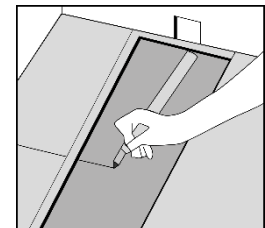

Start next row with the piece leftover (must be at least 30cm (12") long), ensuring that end joints are staggered at least 30cm (12").
Place the first plank of the new row with the tongue side matching the groove side of the plank in the previous row and then press it down with the help of a hand roller, or slightly tap with a rubber hammer.

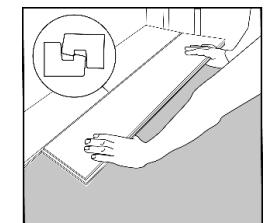



cork

Go
Essence
Resist⁺



stone

Go
Essence
Resist⁺
Hydrocork



wood

Go
Essence
Resist⁺
Resist⁺
Hydrocork

Place the second plank ensuring that no joint is noticed between short sides by certifying that the plank is positioned on the integral connection of the plank in the previous row. At the same time, match the tongue side on the long side of the plank to the groove of the previous row and starting press it down on the short side with the help of a hand roller, or slightly tap with a rubber hammer.

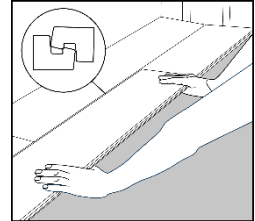

Adjust the distance giving 5mm (0.2") to 10mm (0.4") gap to the wall when three rows are completed and proceed with the installation as described above until reaching the opposite wall.

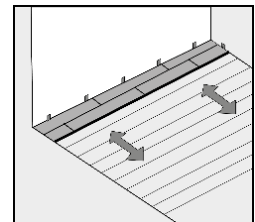

Cut the last plank to the correct width. Place the last plank on top of the second to last row and cut as indicated.

Allow a 5mm (0.2") to 10mm (0.4") distance to the wall for the expansion gap.

The width of the last row of planks should be equal or bigger than 5cm (2").

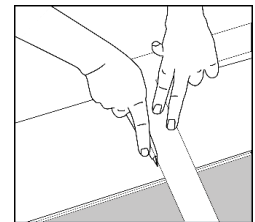

Door Frames

If a door frame needs to be cut, use a piece of plank to obtain the correct height.

Saw the door frame and architrave to the required height allowing for 2mm (0.08") of space to the planks.

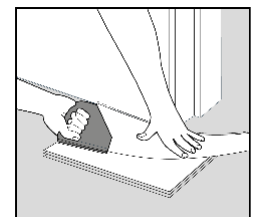

The planks can be laid from all directions. This makes easier to plan the installation e.g. around doors.



cork

Go
Essence
Resist+



stone

Go
Essence
Resist+
Hydrocork



wood

Go
Essence
Resist
Resist+
Hydrocork

Uneven walls

Sometimes the first row must be cut to match an uneven wall.

Transfer the shape of the wall to the planks. Do not forget to allow 5mm (0.2") to 10mm (0.4") for the expansion gap.

The width of the first row of planks should be equal or bigger than 5cm (2").

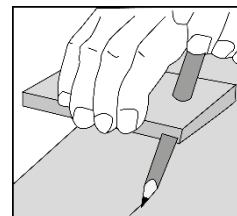

Heating Pipes:

Drill the required holes in the planks, making a hole on the plank 10mm (0.4") bigger than the pipe diameter.

Cut the plank with a 45° angle towards the hole. The cut-off piece is glued in the position again.

Cover the hole with a pipe sleeve.

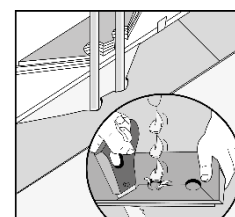
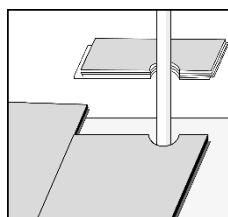

AFTER INSTALLATION

Removing the floor

If you wish to uninstall the floor, start from the opposite side where the installation started. Lift the plank first on the short side and pull up the plank in the long side pressing down the adjacent planks to separate them.

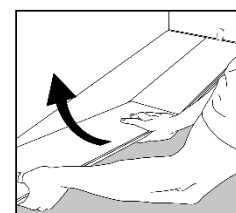



cork

Go
Essence
Resist+



stone

Go
Essence
Resist+
Hydrocork



wood

Go
Essence
Resist
Resist+
Hydrocork

Repairing a damaged plank

Lift the plank that you want to remove a few centimetres: 2 sides of the plank need to be lifted, and the other 2 need to be pressed down, to separate it from the adjacent planks.

Put the new plank into place, by inserting the tongue side under the adjacent planks and pressing it down with the help of a hand roller or slightly tap it with a rubber hammer.

